



Epping Green, Hemel Hempstead

Clements Estate Agents are delighted to offer this fantastic purpose built one bedroom first floor flat in Woodhall Farm which has been completely refurbished throughout. Conveniently situated close to major road links, and all local amenities. This sought after apartment has been completely refurbished and is in immaculate condition throughout. Unfurnished. Available Now!

- Purpose Built Flat
- First Floor Flat
- One Double Bedroom
- Completely Refurbished
- 17'1 Living Room
- Excellent Decorative Order
- Close to Major Road Links including the M1 & M25
- Viewing Essential
- Available Now
- Call To View

£1,150 PCM

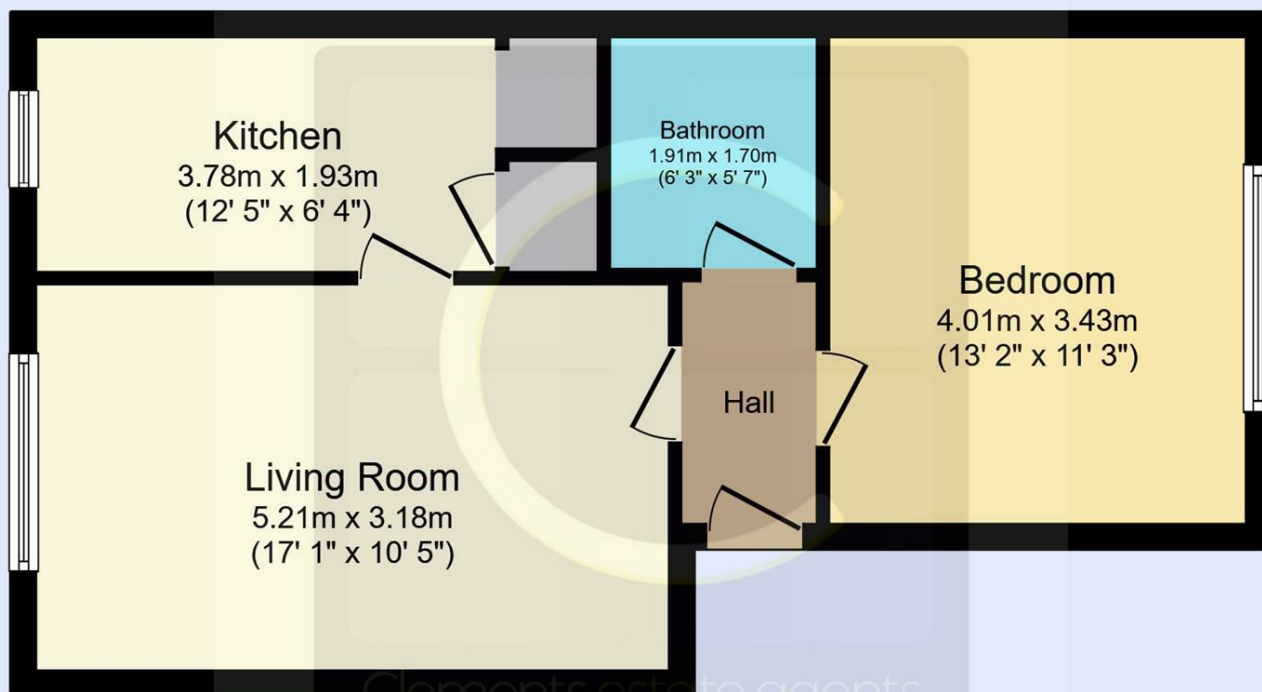

Floor Plan

Floor area 46.1 m² (496 sq.ft.)

TOTAL: 46.1 m² (496 sq.ft.)

This floor plan is for illustrative purposes only. It is not drawn to scale. Any measurements, floor areas (including any total floor area), openings and orientations are approximate. No details are guaranteed, they cannot be relied upon for any purpose and do not form any part of any agreement. No liability is taken for any error, omission or misstatement. A party must rely upon its own inspection(s). Powered by www.Propertybox.io

Clements
estate agents

Energy Efficiency Rating		Current	Potential
Very energy efficient - lower running costs			
(92 plus) A			
(81-91) B			
(69-80) C			
(55-68) D			
(39-54) E			
(21-38) F			
(1-20) G			
Not energy efficient - higher running costs			
		70	82
England & Wales		EU Directive 2002/91/EC	

Environmental Impact (CO ₂) Rating		Current	Potential
Very environmentally friendly - lower CO ₂ emissions			
(92 plus) A			
(81-91) B			
(69-80) C			
(55-68) D			
(39-54) E			
(21-38) F			
(1-20) G			
Not environmentally friendly - higher CO ₂ emissions			
England & Wales		EU Directive 2002/91/EC	